

1595 NW Gilman Blvd., Suite 1  
Issaquah, WA 98027  
www.rowleyproperties.com



To view this space or discuss  
details, please contact  
Kelly Richardson at 425.395.9577

## Location

- 1275 12th Avenue NW, Suite 11
- Approximately 368 sf
- Located 1 block South of Gilman Blvd.
- Adjacent to Issaquah Transit Center

## Features

- Individual office space
- Open space
- Natural light
- Efficient floor plan
- Private space
- Ample parking

## Neighborhood Amenities

- 20 minutes to Seattle, 15 minutes to Bellevue, 5 minutes to Trails
- Located at the Gateway to Issaquah at I-90 Exit 15
- Excellent access via SR 900, Gilman Blvd. and I-90 with 128,000 vehicles per day
- Walking distance to restaurants, banks, retail and fitness options



View [The Law of Real Estate Agency](#) for Washington State. The information contained in this document and any attachment may be confidential and/or legally privileged and has been sent for the sole use of the intended recipient. If you are not an intended recipient, you are not authorized to review, use, disclose or copy any of its contents.

1595 NW Gilman Blvd., Suite 1  
Issaquah, WA 98027  
www.rowleyproperties.com



To view this space or discuss  
details, please contact  
Kelly Richardson at 425.395.9577

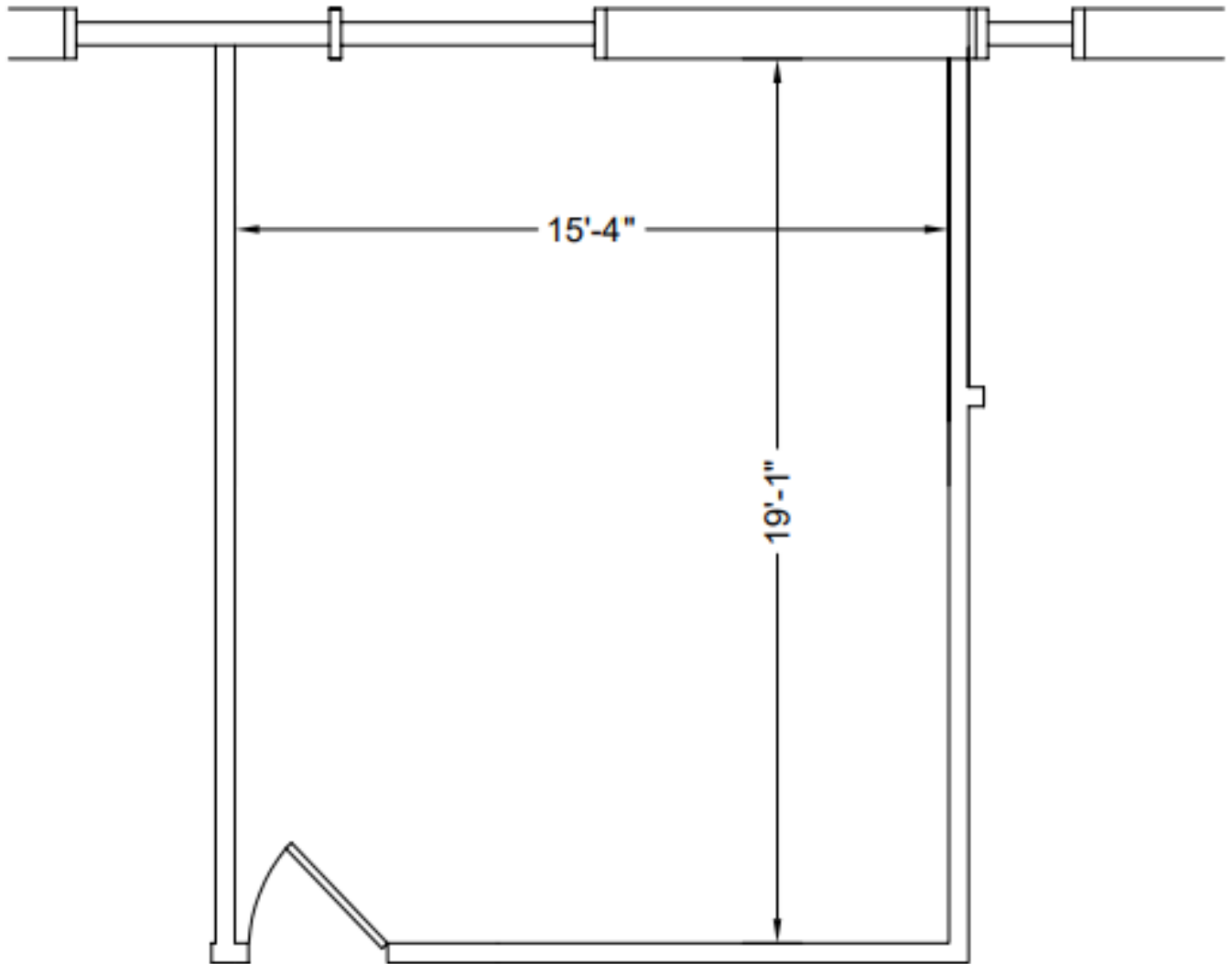

View [The Law of Real Estate Agency](#) for Washington State. The information contained in this document and any attachment may be confidential and/or legally privileged and has been sent for the sole use of the intended recipient. If you are not an intended recipient, you are not authorized to review, use, disclose or copy any of its contents.